

TTC

International interface

Advanced Setup/Troubleshooting



TTC Scrolling

1 Row Scrolling

Select zones to scroll
Press both view area select and enter together
Selected rows will scroll
View zone(s) in a group
View rows automatically

2 Zone Scrolling

Select zones to scroll
Press both change area select and enter together
Selected zones will scroll
View zone(s) in a group individually

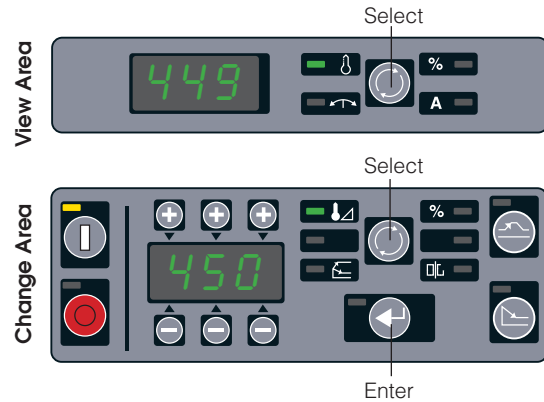

Errors



Power Up Error

E-0 = No zones found
E-1 = Configuration mismatch

Solutions (Change Area - Enter)

Instruct the interface to do one of the following:
1 - Read configuration from system (recommended)
2 - Send configuration to system from interface
3 - Locate zones (zone finder)

Menu Load Error

E-2 = Menu mismatch, will not load, press enter to clear



Gammaflux®



Gammaflux

Sterling, VA USA Tel. +1-(703) 471-5050
Wiesbaden, Germany Tel. +49-(0)-611-973430
Ube, Japan Tel. +81-(836) 54-4369
Singapore Tel. +65-901-83710
www.gammaflux.com; www.gammaflux.de

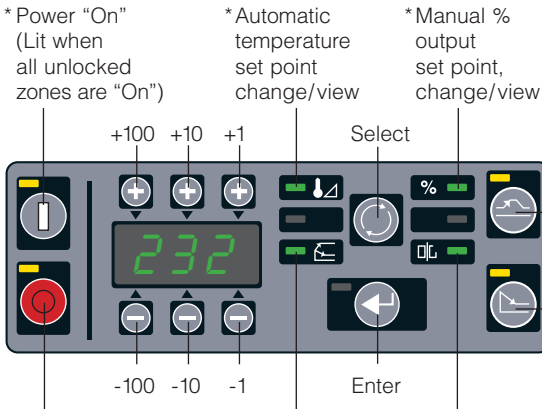
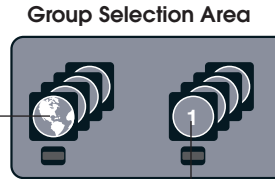
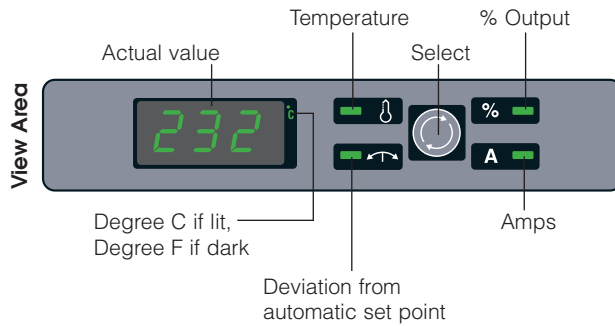
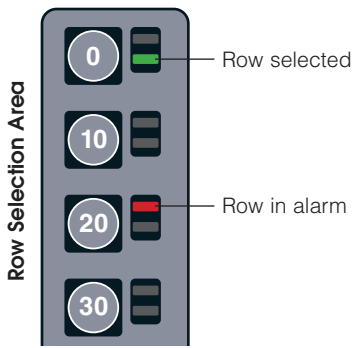

"All Group" – Selects all zones in the system

* "Custom Group" – Stores user zone group. Select zones to save, press custom group button until flashes (5 seconds)

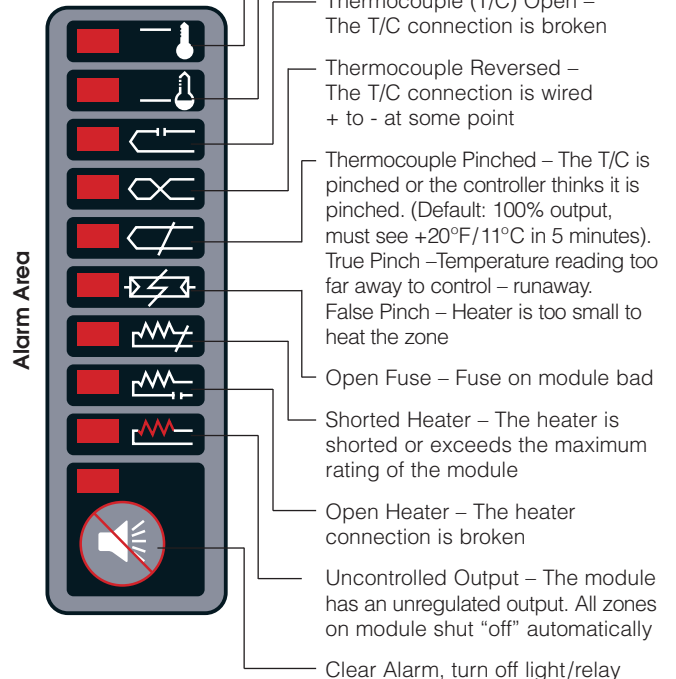
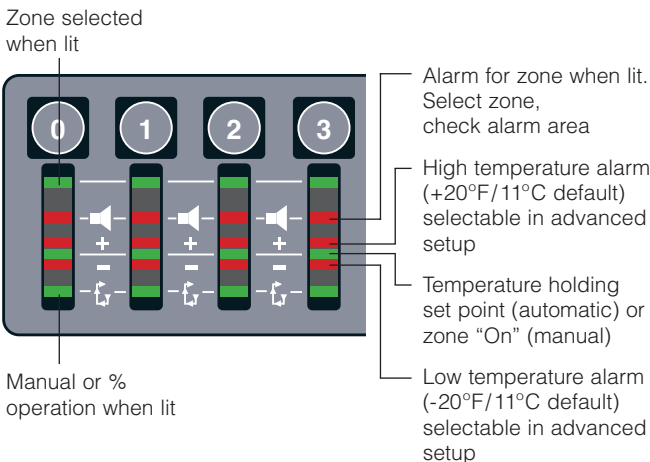
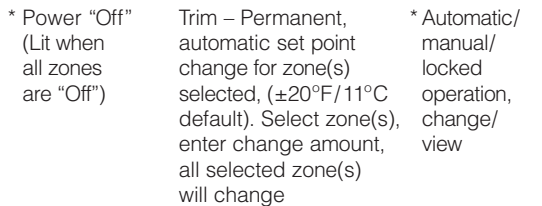

* Saved in menu

Advanced Setup

The TTC International interface is shipped to the customer so that no setup work is required for basic operation. Set points in automatic and manual may be entered and the zone will be controlled by turning "On" the zone power. Many customers require advanced features to satisfy their operation. This page will describe the basics of "Advanced Setup". Please note that security levels are not standard. To place security on the TTC International Interface you must activate security by selecting your own personalized security codes.

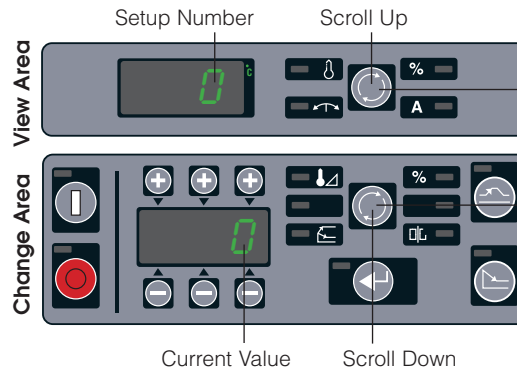

Access/Exit Advanced Setup
Press both select buttons at the same time, hold and release. Selection LED's go dark in advanced setup mode.

Advanced Setup Guide – Level 2 Security to Change

#	Limit (default)	Explanation (*saved in menu)	Set individually by zone
(0)	0-10 (0)	Restore mold setup – access advanced setup. 0 – view area. Select menu 1-10. Enter to restore	
(1)	0-10 (0)	Save mold setup – access advanced setup. 1 – view area. Select menu 1-10. Enter to save	
(2)	+/-100°F/55°C (20°F/11°C)	* Boost temperature set point. 2 – view area. Amount of temperature added to automatic set point during a boost	
(3)	0-300 seconds (60)	* Boost time set point. 3 – view area. The amount of time boost is active	
(4)	-31 to 27 (0)	Algorithm set point (view only). View auto tuning selection or manual tuning value.	
(5)	0-1000°F/537°C (20°F/11°C)	* Temperature deviation alarm set point. Actual temperature activates individual zone alarm at this amount +/- set point	
(6)	0-1000°F/537°C (220°F/104°C)	* Standby set point (individual). When standby is activated, all automatic zones in the standby group will control to this set point	
(7)	-31 to 27 (0)	* Control algorithm adjustment (individual). 0 = auto selection. To view actual tuning value select code 4 Manual Selections: 10 to 17 fast tuning with increasing lag. 20 to 27 slow tuning with increasing lag -1 = very fast tuning; -17 to -10 fast manifold tuning with increasing lag. -27 to -20 very fast tuning with increasing lag -30 and -31 ultra fast low mass tuning. P = auto selection tune performed (view area)	
(8)	0 to 54.0 minutes (5)	T/C pinched detection time (individual). 0 = normal (98+% output, 20°F/11°C in 5 minutes). Change alarm timer amount	
(9)	0-1000°F/537°C (999°F/537°C)	* Critical over temperature alarm. If this temperature is exceeded for 8 seconds, all zones in automatic are turned "Off"	
(10)	0-1000°F/537°C (999°F/537°C)	* Automatic set point limit. The maximum set point an operator can enter in automatic	
(11)	0-100% (100%)	* Manual set point limit. The maximum set point an operator can enter in manual	
(12)	0-1000°F/537°C (50°F/28°C)	* Boost limit. The maximum amount of degrees an operator can raise or lower the zone(s) during a boost	
(13)	0-1000°F/537°C (100°F/56°C)	* Trim limit. The maximum amount of degrees an operator can permanently change the zone(s) during a trim	
(14)	0 or 1 (0)	* Enable material protection input. Must see input repeat in time selected or will activate standby group. 0 = "Off"; 1 = "On"	
(15)	0 to 1000 seconds (0)	* Material protection time. Amount of time from 22-132 VAC/VDC input signal to activate standby group unless signal repeats	
(16)	0-2 (0 = all zones)	* Set standby group. Select zone(s) to go into standby when activated by remote input. 0 = all; 1 = display; 2 = store	
(17)	0-2 (0 = all zones)	* Set slaved power-up group. Select zone(s) to heat within 20°F/11°C of one another until set point. 0 = all; 1 = display; 2 = store	
(18)	0-4 (0)	* Power Priority™. 0 = (off). 1-4 = increased smoothing of power output. A = Power Priority™ is active (view area)	
(19)	0 or 1 (0)	Enabled slaved power-up. 0 = "Off"; 1 = "On"	
(20)	0 or 1 (0)	* Degree F or C selection. 0 = "degree F"; 1 = "degree C"	
(21)	0 or 1 (0)	Type J or K thermocouple selection. 0 = "type J"; 1 = "type K"	
(22)	0 or 1 (0)	Zone power status on power up. 0 = "all zones turned Off"; 1 = "zones On when shut down last, stay On"	
(23)	---	* Reserved for future use	
(24)	---	Reserved for future use	
(25)	0-999 (none)	Security code level 1. You must be in level 2 to change. Refresh procedure available, call Gammaflux	
(26)	0-999 (none)	Security code level 2. You must be in level 2 to change. Refresh procedure available, call Gammaflux	
(27)	0-999 (custom)	Zone finder (locate zones). Finds new hardware, to activate enter 999. Displays number of zones available in the system	
(28)	0 (0)	LED test. To activate, enter 0. Turns "On" all LEDs for troubleshooting	
(29)	---	Output module software version number (display only), select zone, version displayed	
(30)	---	Output module software revision number (display only), select zone, revision displayed	
(31)	---	T/C input software version number (display only), select zone, version displayed (16 zones per module)	
(32)	---	T/C input software revision number (display only), select zone, revision displayed (16 zones per module)	
(33)	---	Data concentrator software version number (display only), select zone, version displayed	
(34)	---	Data concentrator software revision number (display only), select zone, revision displayed	
(35)	---	Operator panel software version number (display only), version displayed	
(36)	---	Operator panel software revision number (display only), revision displayed	
(37)	000-999 (level 2)	Security level indicated. 0 = lockout; 1 = operator; 2 = supervisor; 0 - enter, drops one level Elevate one security level at a time with your customized code	

